

- PUBLIC REALM MATERIALS KEY:**
- PAVING:**
- Granite paving**
Product: Granite paving by Marshall.
Size: 150mm gauge by 600mm TBC. (Engineer to confirm thickness)
Colour/Finish: Mtl. Brown, fine packed (D2). (Grades, fine packed (D2)).
Bond: Staggered, 4-10mm mortar joints.
Laying: Bedding & sub base to Engineers specification
 - Concrete Block paving (exposed aggregate surface)**
Product: Methyl by Marshall.
Size: 100mm gauge by 240mm. (Engineer to confirm thickness)
Colour/Finish: Mtl. Silver Grey (D2) / Charcoal (D2). Textured top.
Bond: Staggered, sand joints. Laying: Bedding & sub base to Engineers specification
 - Concrete Block paving (exposed aggregate surface)**
Product: Methyl by Marshall.
Size: 100mm gauge by 240mm. (Engineer to confirm thickness)
Colour/Finish: Silver Grey. Flat top finish. Bond: Staggered, sand joints.
Laying: Bedding & sub base to Engineers specification
 - Concrete Block paving (exposed aggregate surface)**
Product: Methyl by Marshall.
Size: 100mm gauge by 240mm. (Engineer to confirm thickness)
Colour/Finish: Charcoal flat top finish. Bond: Staggered, sand joints.
Laying: Bedding & sub base to Engineers specification
 - Granite paving to crossing point and vehicle area**
Product: GRANITE Dark Green Granite by Marshall.
Size: Set size TBC. (Engineer to confirm thickness)
Colour/Finish: Dark Green Granite. Bond: Staggered, 4-10mm mortar joints.
Laying: Bedding & sub base to Engineers specification
 - Concrete Block paving (exposed aggregate surface)**
Product: Methyl by Marshall.
Size: 100mm gauge by 240mm. (Engineer to confirm thickness)
Colour/Finish: Granite. Flat top finish. Bond: Staggered, sand joints.
Laying: Bedding & sub base to Engineers specification

- KERBS & EDGES:**
- Concrete Edge Detail**
Product: Methyl by Marshall.
Size: 120 x 100mm. (Engineer to confirm thickness)
Colour/Finish: Silver Grey.
 - Concrete Edge Detail (double course)**
Product: Methyl by Marshall.
Size: 120 x 100mm. (Engineer to confirm thickness)
Colour/Finish: Granite.
 - Granite Kerb**
Product: Granite kerb by Marshall.
Size: 300 x 100mm. (Engineer to confirm depth)
Colour/Finish: GRANITE, fine packed. Chamfered profile to leading edge.
90 degree internal and external returns, transition and radius units as required.
 - Granite Kerb**
Product: Granite kerb by Marshall.
Size: 150 x 100mm. (Engineer to confirm depth)
Colour/Finish: GRANITE, fine packed.
 - Tactile Courtyard Paving - Granite**
Product: Tactile Paving by Marshall.
Size: 400mm min width, 400mm x 400mm module
Colour/Finish: Silver Grey Granite.
 - Tactile Blister Paving - Granite**
Product: Tactile Paving by Marshall.
Size: 400mm min width, 400mm x 400mm module
Colour/Finish: Silver Grey Granite.

- STREET FURNITURE:**
- Tree Cella (to avenue street trees)**
Product: G1 Moss-Fave Tree Cella by Green-Tech or similar approved.
Size: 1500 x 1500mm.
Colour: Galvanized frame infilled with P2 paving to match adjacent surface.
Laying: Bedding & sub base to Engineers specification
 - Ballard (Round)**
Product: Ballard ball top anti-rim bollard with hazard bonding or similar approved.
Size: 100mm (above ground) x 110mm diameter.
Colour/Finish: 316 grade stainless steel.
Installation: Route fixed to manufacturers / Engineers specification

- LIGHTING:**
- Interchange Pedestrian Lighting**
Product: Ball pole mounted luminaire or similar approved.
Size: 4m column.
Colour: Silver / Light Grey.
Specification and location to lighting Engineers design.
 - Interchange Street Lighting**
Product: Twin mast high-mast DDL luminaire or similar approved.
Size: 12m column.
Colour: Silver / Light Grey.
Specification and location to lighting Engineers design.

CAD Reference: J125691/125698-Interchange/Drawings

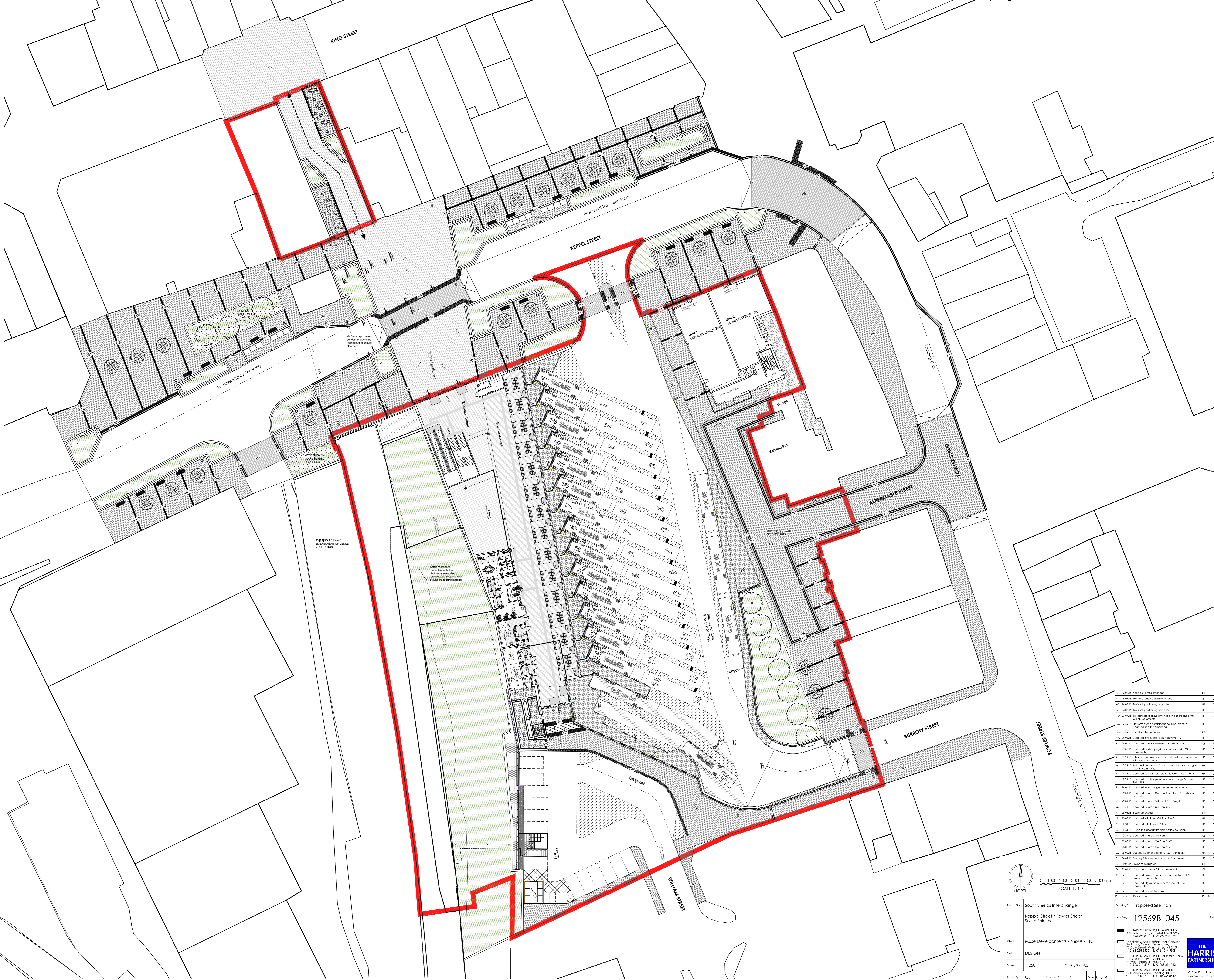

Ref	Description	Rev	By	Check
AC	125691-125698-Interchange/Drawings	01	CB	HP
AC	125691-125698-Interchange/Drawings	02	CB	HP
AC	125691-125698-Interchange/Drawings	03	CB	HP
AC	125691-125698-Interchange/Drawings	04	CB	HP
AC	125691-125698-Interchange/Drawings	05	CB	HP
AC	125691-125698-Interchange/Drawings	06	CB	HP
AC	125691-125698-Interchange/Drawings	07	CB	HP
AC	125691-125698-Interchange/Drawings	08	CB	HP
AC	125691-125698-Interchange/Drawings	09	CB	HP
AC	125691-125698-Interchange/Drawings	10	CB	HP
AC	125691-125698-Interchange/Drawings	11	CB	HP
AC	125691-125698-Interchange/Drawings	12	CB	HP
AC	125691-125698-Interchange/Drawings	13	CB	HP
AC	125691-125698-Interchange/Drawings	14	CB	HP
AC	125691-125698-Interchange/Drawings	15	CB	HP
AC	125691-125698-Interchange/Drawings	16	CB	HP
AC	125691-125698-Interchange/Drawings	17	CB	HP
AC	125691-125698-Interchange/Drawings	18	CB	HP
AC	125691-125698-Interchange/Drawings	19	CB	HP
AC	125691-125698-Interchange/Drawings	20	CB	HP
AC	125691-125698-Interchange/Drawings	21	CB	HP
AC	125691-125698-Interchange/Drawings	22	CB	HP
AC	125691-125698-Interchange/Drawings	23	CB	HP
AC	125691-125698-Interchange/Drawings	24	CB	HP
AC	125691-125698-Interchange/Drawings	25	CB	HP
AC	125691-125698-Interchange/Drawings	26	CB	HP
AC	125691-125698-Interchange/Drawings	27	CB	HP
AC	125691-125698-Interchange/Drawings	28	CB	HP
AC	125691-125698-Interchange/Drawings	29	CB	HP
AC	125691-125698-Interchange/Drawings	30	CB	HP
AC	125691-125698-Interchange/Drawings	31	CB	HP
AC	125691-125698-Interchange/Drawings	32	CB	HP
AC	125691-125698-Interchange/Drawings	33	CB	HP
AC	125691-125698-Interchange/Drawings	34	CB	HP
AC	125691-125698-Interchange/Drawings	35	CB	HP
AC	125691-125698-Interchange/Drawings	36	CB	HP
AC	125691-125698-Interchange/Drawings	37	CB	HP
AC	125691-125698-Interchange/Drawings	38	CB	HP
AC	125691-125698-Interchange/Drawings	39	CB	HP
AC	125691-125698-Interchange/Drawings	40	CB	HP
AC	125691-125698-Interchange/Drawings	41	CB	HP
AC	125691-125698-Interchange/Drawings	42	CB	HP
AC	125691-125698-Interchange/Drawings	43	CB	HP
AC	125691-125698-Interchange/Drawings	44	CB	HP
AC	125691-125698-Interchange/Drawings	45	CB	HP
AC	125691-125698-Interchange/Drawings	46	CB	HP
AC	125691-125698-Interchange/Drawings	47	CB	HP
AC	125691-125698-Interchange/Drawings	48	CB	HP
AC	125691-125698-Interchange/Drawings	49	CB	HP
AC	125691-125698-Interchange/Drawings	50	CB	HP
AC	125691-125698-Interchange/Drawings	51	CB	HP
AC	125691-125698-Interchange/Drawings	52	CB	HP
AC	125691-125698-Interchange/Drawings	53	CB	HP
AC	125691-125698-Interchange/Drawings	54	CB	HP
AC	125691-125698-Interchange/Drawings	55	CB	HP
AC	125691-125698-Interchange/Drawings	56	CB	HP
AC	125691-125698-Interchange/Drawings	57	CB	HP
AC	125691-125698-Interchange/Drawings	58	CB	HP
AC	125691-125698-Interchange/Drawings	59	CB	HP
AC	125691-125698-Interchange/Drawings	60	CB	HP
AC	125691-125698-Interchange/Drawings	61	CB	HP
AC	125691-125698-Interchange/Drawings	62	CB	HP
AC	125691-125698-Interchange/Drawings	63	CB	HP
AC	125691-125698-Interchange/Drawings	64	CB	HP
AC	125691-125698-Interchange/Drawings	65	CB	HP
AC	125691-125698-Interchange/Drawings	66	CB	HP
AC	125691-125698-Interchange/Drawings	67	CB	HP
AC	125691-125698-Interchange/Drawings	68	CB	HP
AC	125691-125698-Interchange/Drawings	69	CB	HP
AC	125691-125698-Interchange/Drawings	70	CB	HP
AC	125691-125698-Interchange/Drawings	71	CB	HP
AC	125691-125698-Interchange/Drawings	72	CB	HP
AC	125691-125698-Interchange/Drawings	73	CB	HP
AC	125691-125698-Interchange/Drawings	74	CB	HP
AC	125691-125698-Interchange/Drawings	75	CB	HP
AC	125691-125698-Interchange/Drawings	76	CB	HP
AC	125691-125698-Interchange/Drawings	77	CB	HP
AC	125691-125698-Interchange/Drawings	78	CB	HP
AC	125691-125698-Interchange/Drawings	79	CB	HP
AC	125691-125698-Interchange/Drawings	80	CB	HP
AC	125691-125698-Interchange/Drawings	81	CB	HP
AC	125691-125698-Interchange/Drawings	82	CB	HP
AC	125691-125698-Interchange/Drawings	83	CB	HP
AC	125691-125698-Interchange/Drawings	84	CB	HP
AC	125691-125698-Interchange/Drawings	85	CB	HP
AC	125691-125698-Interchange/Drawings	86	CB	HP
AC	125691-125698-Interchange/Drawings	87	CB	HP
AC	125691-125698-Interchange/Drawings	88	CB	HP
AC	125691-125698-Interchange/Drawings	89	CB	HP
AC	125691-125698-Interchange/Drawings	90	CB	HP
AC	125691-125698-Interchange/Drawings	91	CB	HP
AC	125691-125698-Interchange/Drawings	92	CB	HP
AC	125691-125698-Interchange/Drawings	93	CB	HP
AC	125691-125698-Interchange/Drawings	94	CB	HP
AC	125691-125698-Interchange/Drawings	95	CB	HP
AC	125691-125698-Interchange/Drawings	96	CB	HP
AC	125691-125698-Interchange/Drawings	97	CB	HP
AC	125691-125698-Interchange/Drawings	98	CB	HP
AC	125691-125698-Interchange/Drawings	99	CB	HP
AC	125691-125698-Interchange/Drawings	100	CB	HP

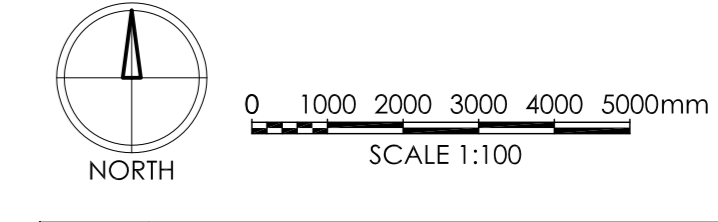

Project: South Shields Interchange
Keppel Street / Fowler Street
South Shields

Proposed Site Plan
Drawing No: 12569B_045
Rev: AH

Client: MUSE DEVELOPMENTS / NEXUS / STC
 Status: DESIGN
 Scale: 1:250
 Drawing Size: A0
 Date: 04/14

THE HARRIS PARTNERSHIP
 270 FLOORS, COLWYN MOUNTAINS, 2015
 T: 01492 291 800 F: 01492 290 072
 T: 01492 290 800 F: 01492 290 072
 THE HARRIS PARTNERSHIP, 270 FLOORS, COLWYN MOUNTAINS, 2015
 T: 01492 291 800 F: 01492 290 072
 THE HARRIS PARTNERSHIP, 270 FLOORS, COLWYN MOUNTAINS, 2015
 T: 01492 291 800 F: 01492 290 072